

Feiyu SCORP Pro Specs

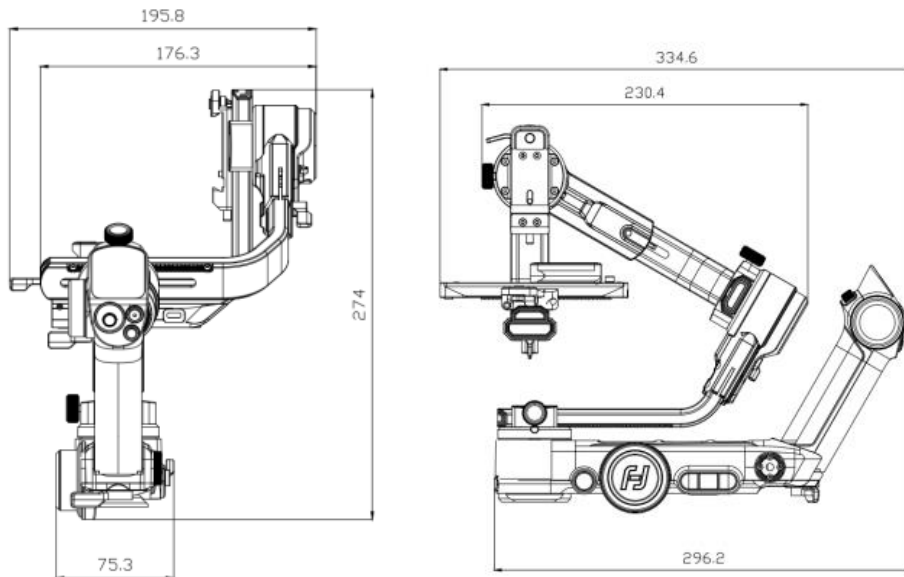

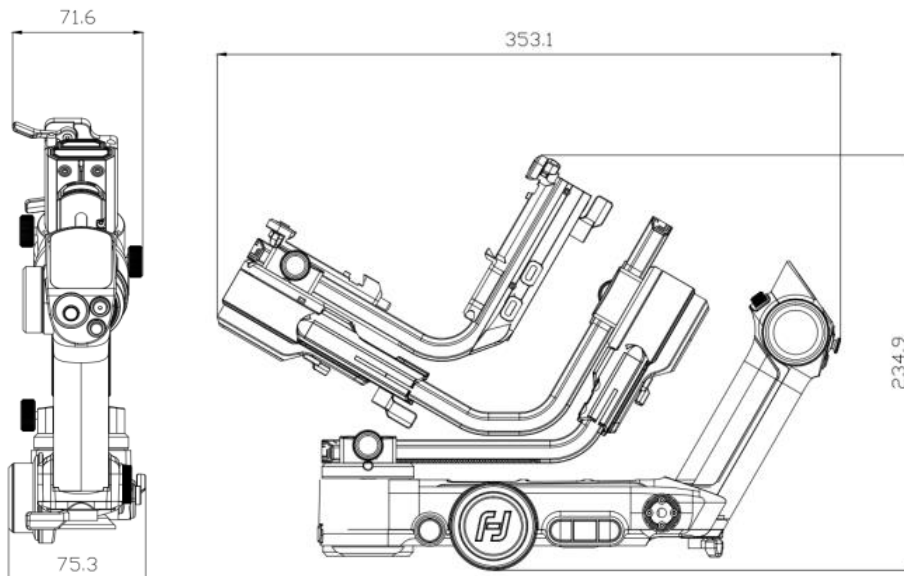

Product Name	Feiyu SCORP Pro 3-Axis Camera Handheld Stabilizer
Battery Capacity	2500mAh, built-in battery cannot be removed, charge it via the USB-C port on gimbal, support all the normal charger and quick charger which charging power $\leq 18W$
Operating Voltage	13V-16.8V
Theoretical Battery Life	12h
Charging Time	About 2.75h (Using 18W fast charger)
Materials In Main Body	Synthetic macromolecular resin, aluminum alloy
Weight	About 2100g/4.63 lb (including quick release plate, not included other accessories and camera)
Payload	About 4.8kg/10.58 lb (well balanced)
Water-Proof Grade	Not Water-proof
Dimensions	334.6*195.8*274mm (Gimbal balancing position)



353.1*75.3*234.9mm (Gimbal folded position)



Compatible Cameras	Sony, Canon, Nikon, Panasonic camera etc (Check Camera Compatibility Lists for more details)
Operating Temperature	$-10^{\circ}\text{C} \sim 45^{\circ}\text{C}$
Rotatable Range	Tilt: 340° (With limitation) Roll: 340° (With limitation) Pan: 360° (Unlimited)

Controllable Range	Tilt: +110° ~-45° Roll: +20° ~-20° Pan: 360° (Unlimited)
Quick Release Plate	Quick release plate (133x50x11mm) and optional camera backing base (50x38x14mm) are compatible with Manfrotto 60° quick release system. Can be removed from the gimbal together with the camera, and fast switch between popular quick release systems without re-assembling the camera.
Follow Mode	 PF: Pan follow, only the pan axis follows the movement of user's hand  PTF: Pan and tilt follow, where both the pan and tilt axes follow the movement of user's hand, but roll axis does not  FPV: Pan, tilt and roll follow, where all 3 axes follow the movement of user's hand  Lock: All 3 axes do not follow the movement of user's hand, gimbal keeps the direction of the camera fixed  FFW: flash follow, pan, where all 3 axes follow the movement of user's hand in high follow speed
APP	Feiyu SCORP
How To Control The Camera	While connecting gimbal and cameras with cable (standard accessories for SONY, CANON, NIKON, Panasonic), users can control picture-taking/recording with shutter button and set aperture, shutter, ISO and other camera parameters (see Camera Compatibility List for more).
Motor Power Auto Tune	Auto Tune motor power is available to the App or Touch Screen. Gimbal auto tune the motor power according to the camera you install. Auto Tune operation: Enter the motor power setting through touch screen, and tap Auto Tune, then put gimbal on the table until the display prompt calibration complete. Gimbal will vibrate slightly while Auto Tune to weigh the camera, it's a normal phenomenon.
Extended	At the bottom of the gimbal: 3/8 inch thread hole*1, with the 3/8- 1/4 inch thread insert (Standard accessory), user can also mount Tripod which using 1/4 inch screw;

<p>Ports</p>	<p>At the bottom of the gimbal: ARCA quick release base plate *1, can fast mount gimbal on popular quick release systems without re-assembling camera;</p> <p>At the right side of handle versatile cross arm: Type-C charging port*1, charge for gimbal and remote control handle;</p> <p>At the left and right side of versatile cross arm: ARRI rosettes*2;</p> <p>At the end of versatile cross arm: quick release mount for remote control handle *1, for installation of remote control handle;</p> <p>In front of fixed plate: Type-C extension port*2 to connect focus motors;</p> <p>At the back of fixed plate: Type-C camera control port*1, Type-C image transmission port*1;</p> <p>In front of quick release plate: 1/4 inch thread hole*1, for installation of lens holder;</p> <p>At the bottom of the remote control handle: Type-C charging port*1, handle charging only;</p>
<p>Standard Accessories</p>	<p>Feiyu SCORP Pro*1</p> <p>Remote control handle*1</p> <p>Data cable USB 2.0 to Type-C*1</p> <p>Shutter cable Type-C to Micro(A03)*1</p> <p>Shutter cable Type-C to Mini (B02)*1</p> <p>Shutter cable Type-C to Type-C (C02)*1</p> <p>Shutter cable Type-C to TRS2.5 (T02)*1</p> <p>Sony shutter cable Type-C to Multi*1</p> <p>Panasonic shutter cable (DC2.5mm) Type-C to 2.5mm*1</p> <p>Tripod*1</p> <p>Quick release plate*1</p> <p>Camera backing base*1</p> <p>Lens holder*1</p> <p>Lens holder screw*1</p> <p>Camera fixed screw*3</p> <p>3/8- 1/4 inch thread insert (The thread insert is factory mounted on tripod)*1</p> <p>Storage bag*1</p>

<p>Optional Accessories</p>	<p>Monopod (Pay attention to its max payload);</p> <p>Feiyu SCORP Focus Motor;</p> <p>Feiyu SCORP Image Transmission Transmitter;</p> <p>Gimbal Cage for Feiyu SCORP Pro;</p> <p>Dual Handle Grip for Feiyu SCORP Pro;</p> <p>Carbon Fiber Extension Rod;</p> <p>wireless microphone kit: wireless microphone (transmitter terminal)*1、 wireless microphone (receiving terminal)*1, wireless clip-on microphone *1;</p> <p>Body-mounted Weight Support for installing flash lamp/ soft light/ Microphone and other devices via cold shoes;</p>
<p>Available Functions For Users</p>	<ol style="list-style-type: none"> 1. Change follow modes via touch screen/buttons, directly show the state of camera connection, Bluetooth, control object , battery at the display without APP. 2. One tap to enter Auto rotation mode (Inception mode), long exposure timelapse, VLOG Selfie and portrait shooting for TikTok, and more special shooting way. 3. Manually set up the rotation speed, picture interval, long exposure time and the movement route in auto-rotation mode for long exposure timelapse. 4. Built-in vertical mounting plate, which allows the camera to be installed on the gimbal in portrait mode. 5. One tap to switch between portrait and landscape mode. 6. Control picture-taking/recording with shutter button and set aperture, shutter, ISO and other camera parameters (see Camera Compatibility List for more). 7. Remote control gimbal via remote control handle. 8. Flexible axis arm, give more loading space. 9. Customize the some button functions, motor power, follow speed, dead zone, language, etc. 10. Initialize the gimbal when it is not level. 11. Manually set up the shooting angle on tilt axis and pan axis by hand. 12. Upgrade the firmware , set up the parameter, remote control on APP.

**Main
Features**

Max payload updates to 4.8 kg, easily work with popular DSLR and mirrorless cameras.

3 Axis motor-lock design to get a convenient balance and storage.

Detachable handle brings more possibilities for shooting.

Center of gravity memory slider make balancing easier.

Built-in vertical mounting plate, which allows the camera to be installed on the gimbal in portrait mode without extra accessories.

ARCA quick release base plate at the bottom of the gimbal which can fast mount gimbal on popular quick release systems without re-assembling camera.

Touch screen operation without APP to directly set up parameters and change follow mode.

Two-wheel drive, follow focus and zoom more easily.

The magic wheel which can custom operating feel and damping shows more possibilities.

ABC point Trajectory memory, one button to achieve movements your set or automatic focus.

Just touch one icon and you will directly enter Inception mode/ Long exposure timelapse/ VLOG selfie/ TikTok portrait shoot and got more popular shooting ways.

Type-C quick charging port for gimbal, takes only 2.75 hour to fully charge it. Dual available USB ports for external focus motor/Zoom in&out set.

Customize the some button functions, motor power, follow speed, dead zone, language, etc to fit for different usage.

Auto tune motor power and customize motor power to be chose to work with more cameras and lens.

Optional wireless microphone kit for better sound recording, make your VLOG / TikTok video come with sound more easily.